

SD-836140127	2	3
ECN NO.	UM13883	DATE
APP'D BY		REV. BY
REL. BY		
		PART DWG
		REV. ISSUE
		-
		6-4-09

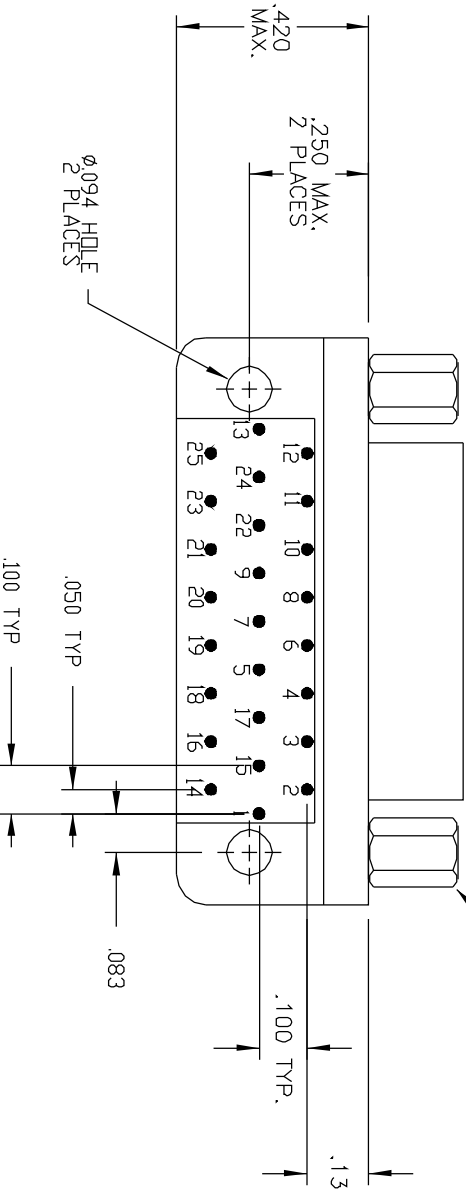
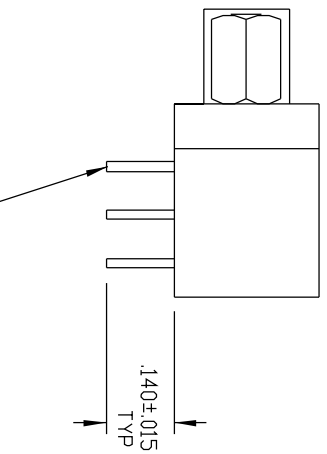
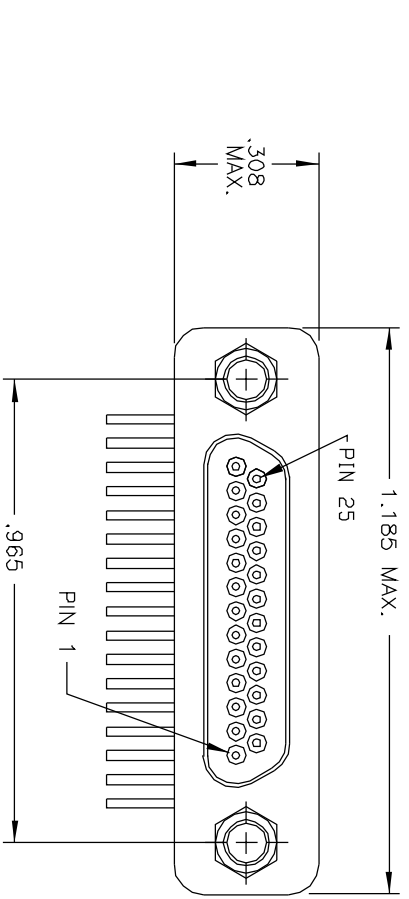

2 MATERIALS:
 SHELL: 6061-T6 ALUMINUM PER QQ-A200/8 CADMIUM PLATED PER AMS-00-P-416
 INSULATOR AND BACKSHELL: PPS PER MIL-M-24519 GST-40F
 PIN CONTACTS: BERYLLIUM COPPER
 PER ASTM-B194, GOLD PLATED PER MIL-G-45204
 24 AWG SOLID WIRE LEADS: TIN PLATED COPPER ALLOY
 HARDWARE: STAINLESS STEEL, PASSIVATED PER QQ-P-35

1. MARKING: UMI, DATE CODE, UMI P/N.

NOTES: UNLESS OTHERWISE SPECIFIED.

QUALITY SYMBOLS	UNLESS SPECIFIED: ALL DIMENSIONS IN INCHES	SCALE	DWG SIZE	THIRD ANGLE PROJECTION	REVISE ON CAD ONLY
MAJOR = 0	GENERAL TOLERANCES:	4:1	B		
MINOR = 0	3 PLACE ±.005	DRAWN BY & DATE			
CRITICAL C = 0	2 PLACE ±.01	DW 6-4-09			
	ANGULAR ±2°	CHECKED BY & DATE			
		APPROVED BY & DATE			
SPC S = 0	UTI-MATE CAGE CODE	CAD FILENAME	PART NO.	DRAWING NO.	SHEET NO.
	58967	SD-836140127.DGN	836140127	SD-836140127	1 OF 1
		THIS DRAWING CONTAINS INFORMATION THAT IS PROPRIETARY TO UTI-MATE INCORPORATED AND SHOULD NOT BE USED WITHOUT WRITTEN PERMISSION.			