

PART REV	DWG ISSUE	DATE	ECN NO.	APPVD BY	REL BY
-	-	6-4-13	UMI 4986	DW	DW

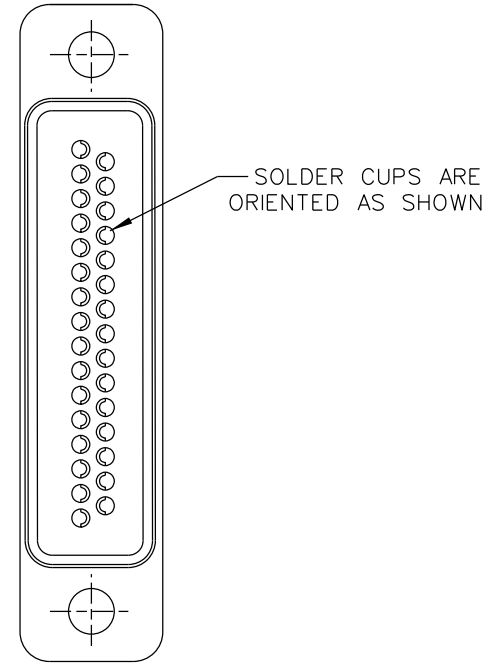
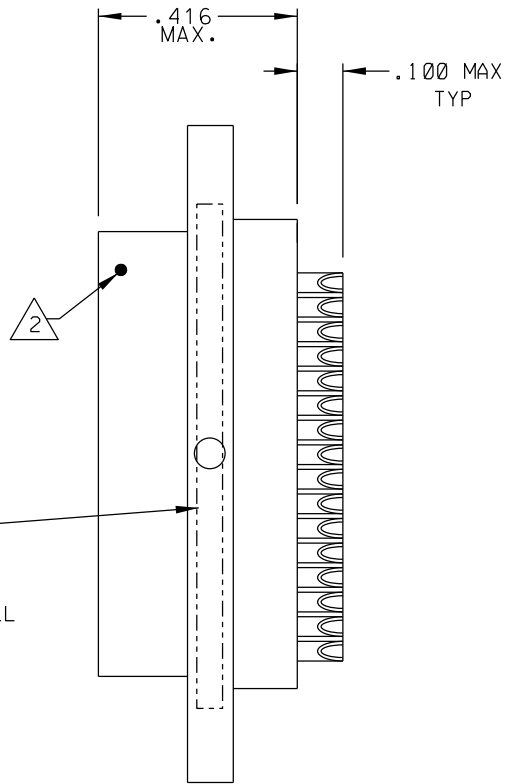
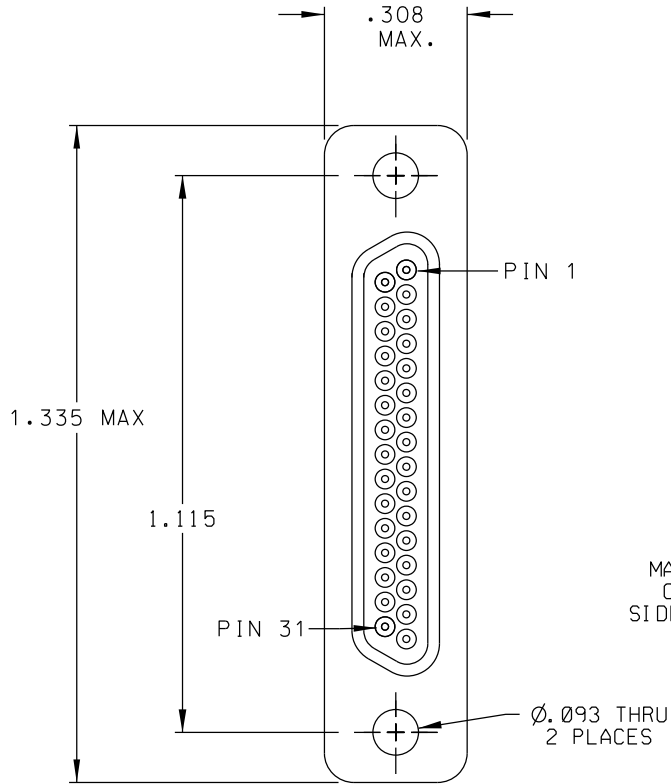

4. PERFORMANCE SPECIFICATIONS: MEETS OR EXCEEDS THE REQUIREMENTS OF MIL-DTL-83513

3 MATERIALS:  
 SHELL: 6061-T6 ALUMINUM PER AMS-QQ-A200/8, CADMIUM PLATED PER AMS-QQ-P-416  
 INSULATOR: PPS PER MIL-M-24519 GST-40F  
 PIN CONTACTS: C17200 BERYLLIUM COPPER PER ASTM-B194,  
 GOLD PLATED PER ASTM B488  
 HARDWARE: STAINLESS STEEL, PASSIVATED PER AMS 2700

2 MARK POSITION 1 WITH A DOT AT LOCATION SHOWN.

1 MARKING: \*M83513/01-EC\*, UMI, AND UMI DATE CODE

NOTES: UNLESS OTHERWISE SPECIFIED.

QUALITY SYMBOLS CRITICAL MAJOR NO SYMBOL MINOR DIMENSION	UNLESS SPECIFIED: ALL DIMENSIONS IN INCHES	SCALE NONE	DWG SIZE B	THIRD ANGLE PROJECTION	REVISE ON CAD ONLY	
	GENERAL TOLERANCES: 3 PLACE ±.005 2 PLACE ±.01 ANGULAR ±2°	DRAWN BY & DATE DW 6-4-13	CHECKED BY & DATE SEE ECN	TITLE: MIL-SPEC MICRO-D PLUG, 31 POSITION, SOLDER CUP PIN CONTACTS, M83513/01-EC		
	Uti-Mate CAGE CODE <b>58967</b>	APPROVED BY & DATE SEE ECN	CAD FILENAME SD-835150000.DGN	PART NO. 835150000	DRAWING NO. SD-835150000	SHEET NO. 1 OF 1
		THIS DRAWING CONTAINS INFORMATION THAT IS PROPRIETARY TO ULTI-MATE INCORPORATED AND SHOULD NOT BE USED WITHOUT WRITTEN PERMISSION.				PART REV -