

PART DWG REV ISSUE	DATE	ECN NO.	APP'D BY	REL BY
-	04-04-17	UMIS296	TPOMBART	PER

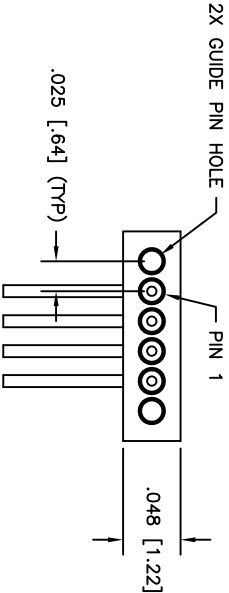
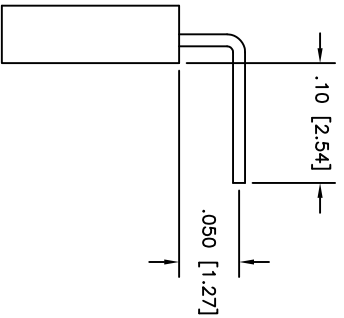
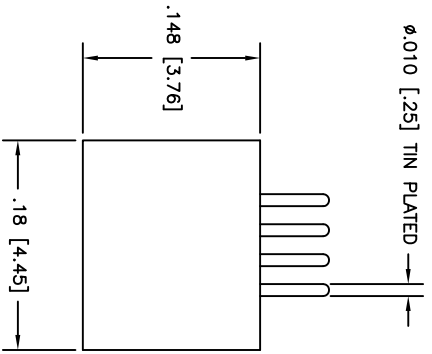

3. PERFORMANCE: MEETS OR EXCEEDS M32139 PERFORMANCE SPECIFICATIONS  
 CONTACT RATING: 1 AMPERE MAXIMUM  
 DMV: 250 VAC  
 INSULATION RESISTANCE: 5000 MEGOHMS MINIMUM @ 100 VDC  
 CONTACT RESISTANCE: 0.021 VOLT MAXIMUM DROP @ 1.0 AMPS (.021 OHMS)

2. MATERIALS: INSULATOR: PPS (POLYPHENTYLENE SULFIDE) GST-40F  
 CONTACTS: BERYLLIUM COPPER PER ASTM B194, GOLD PLATED PER ASTM B488  
 LEADS: TIN PLATED

1. MARKINGS: UMI, DATE CODE, W/O AND PART, UMI P/N ON BAG OR TAG  
 NOTES: UNLESS OTHERWISE SPECIFIED

QUALITY SYMBOLS	UNLESS SPECIFIED, ALL DIMENSIONS IN INCHES	SCALE	DWG SIZE	THIRD ANGLE PROJECTION	REVISE ON CAD ONLY
MAJOR =	GENERAL TOLERANCES:	10:1	B		
CRITICAL =	3 PLACE ±.005	DRAWN BY & DATE			
C =	2 PLACE ±.010	PER 02-24-17			
SPC =	ANGULAR ±2°	CHECKED BY & DATE			
S =		SEE ECN			
		APPROVED BY & DATE			
		SEE ECN			
		CAD FILENAME	PART NO.	DRAWING NO.	Uti-Mate Connector Inc.
		SD-837045122.DWG	837045122	SD-837045122	
		THIS DRAWING CONTAINS INFORMATION THAT IS PROPRIETARY TO Uti-MATE		SHEET NO.	1 OF 1
		INCORPORATED AND SHOULD NOT BE USED WITHOUT WRITTEN PERMISSION.		REV	-

Uti-Mate Connector Inc.