

10

9

8

7

6

5

4

3

2

SD-836250410

PART REV	DWG ISSUE	DATE	ECN NO.	APPVD BY	REL BY
-	-	10/25/18	UMI6925	DW	DW

F

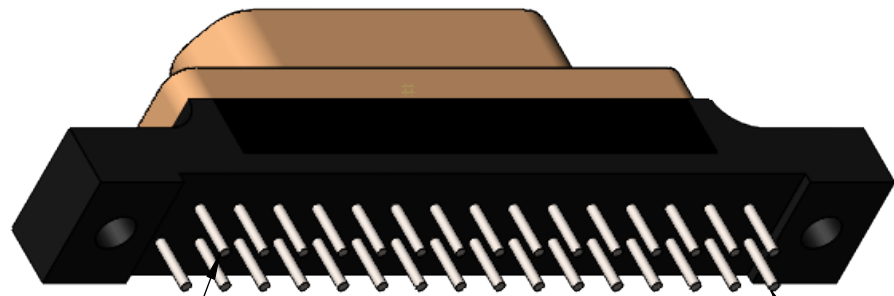

POSITION 31

POSITION 1

PCB VIEW

E

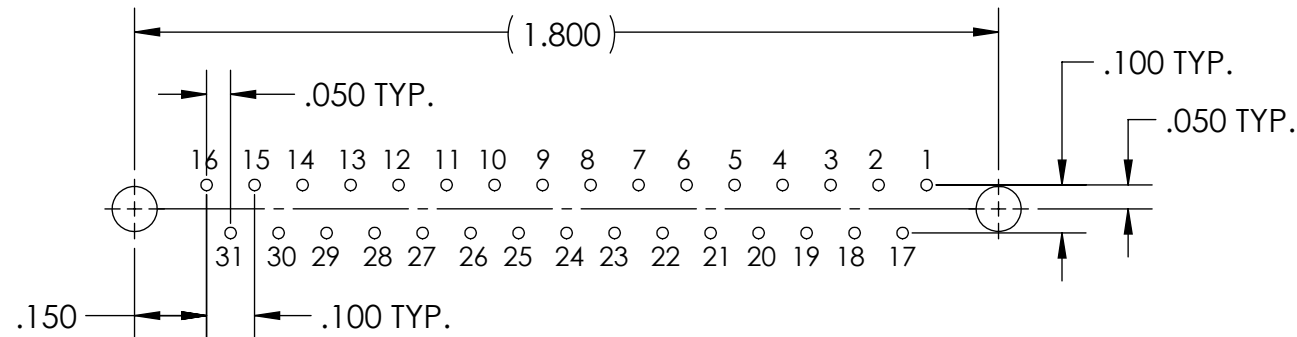

RECOMMENDED PCB LAYOUT

D

C

6. CONTACT HEIGHTS ARE TO BE PER QA-STD-101.

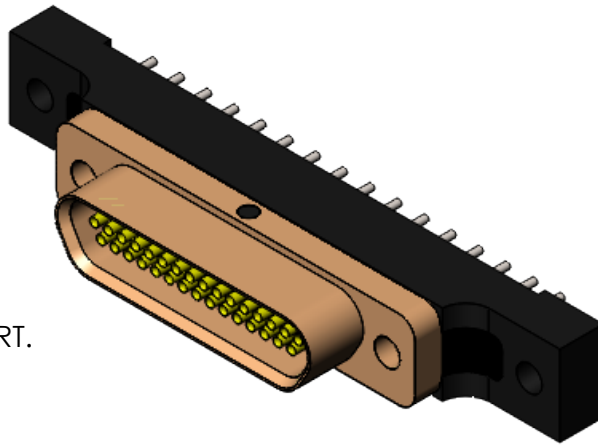

5 NUMBERS, (LEAD LOCATIONS), ARE SHOWN FOR REFERENCE ONLY AND DO NOT APPEAR ON ACTUAL PART.

B

4. PERFORMANCE SPECIFICATIONS:
CURRENT RATING: 3 AMPS MAX.
INSULATION RESISTANCE: 5000 MEGOHMS MIN.
DWV: 600 VAC
TEMPERATURE RATING: -55°C TO 125°C

3 MATERIALS:
SHELL: 6061-T6 ALUMINUM PER AMS-QQ-A200/8, CADMIUM PLATED PER AMS-QQ-P-416
INSULATOR/BACKSHELL: PPS PER MIL-M-24519 GST-40F, COLOR: BLACK
SOCKET CONTACTS: C21000 COPPER ALLOY PER ASTM B36, GOLD PLATED PER ASTM B488
24 AWG LEADS: TIN PLATED COPPER ALLOY PER A-A-59551, TYPE S
INTERFACIAL SEAL: FLUOROSILICONE PER MIL-R-25988

A

2 MARKING: "UMI", DATE CODE, UMI PART NUMBER, UMI WORK ORDER NUMBER

1. CONNECTOR ASSEMBLY IS IAW MIL-DTL-83513 UNLESS OTHERWISE SPECIFIED.

NOTES: UNLESS OTHERWISE SPECIFIED.

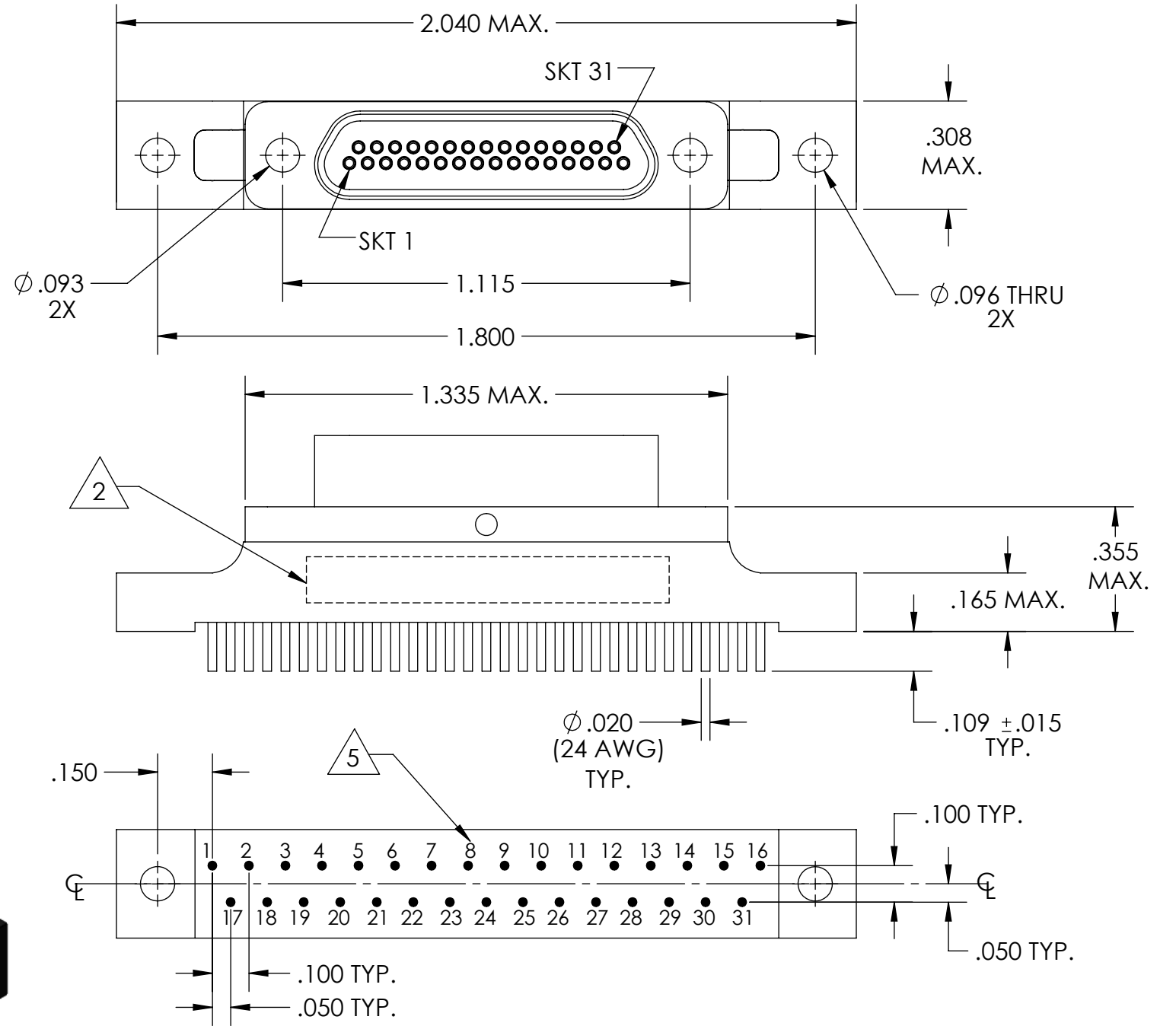

QUALITY SYMBOLS CRITICAL MAJOR NO SYMBOLS = MINOR DIMENSIONS	UNLESS OTHERWISE SPECIFIED: ALL DIMENSIONS ARE IN INCHES	SCALE NONE	DWG SIZE B	THIRD ANGLE PROJECTION	REVISE ON CAD ONLY		
	GENERAL TOLERANCES: 3 PLACES ±.005 2 PLACES ±.01 ANGULAR ±2°	DRAWN BY & DATE DU 10/25/18		TITLE: MICRO-D CIRCUIT CONNECTOR ASSEMBLY, CM4R31S0, CADMIUM PLATED SHELL			
		CHECKED BY & DATE DW 10/25/18		MATERIAL: 3	ENG PROJECT #: NONE		
		APPROVED BY & DATE DW 10/25/18		PART NO. 836250410	DRAWING NO. SD-836250410		
	ULTI-MATE CAGE CODE 58967	CAD FILE NAME SD-836250410.sliddrw	PART NO. 836250410		DRAWING NO. SD-836250410		PART REV. -

THIS DRAWING CONTAINS INFORMATION THAT IS PROPRIETARY TO ULTI-MATE INCORPORATED AND SHOULD NOT BE USED WITHOUT WRITTEN PERMISSION.