

PART REV	DWG ISSUE	DATE	ECN NO.	APPVD BY	REL BY
-	-	10/19/12	UMI4276	DW	DW
-	A	9/16/20	UMI7565	DU	DW

F
E
D
C
B
A

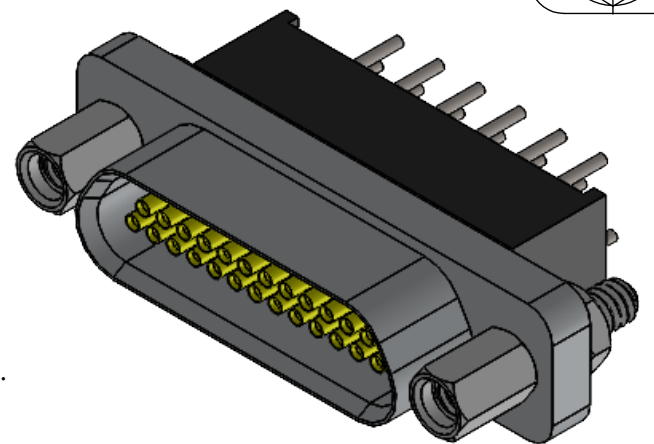
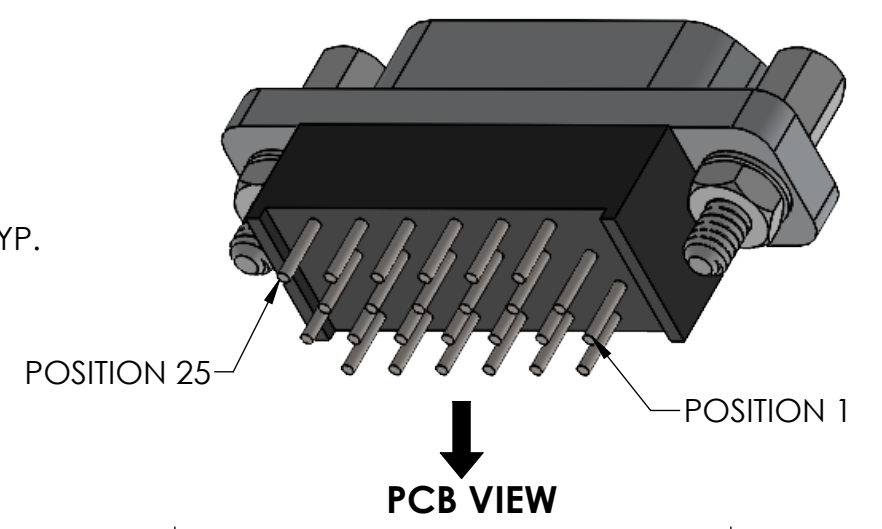
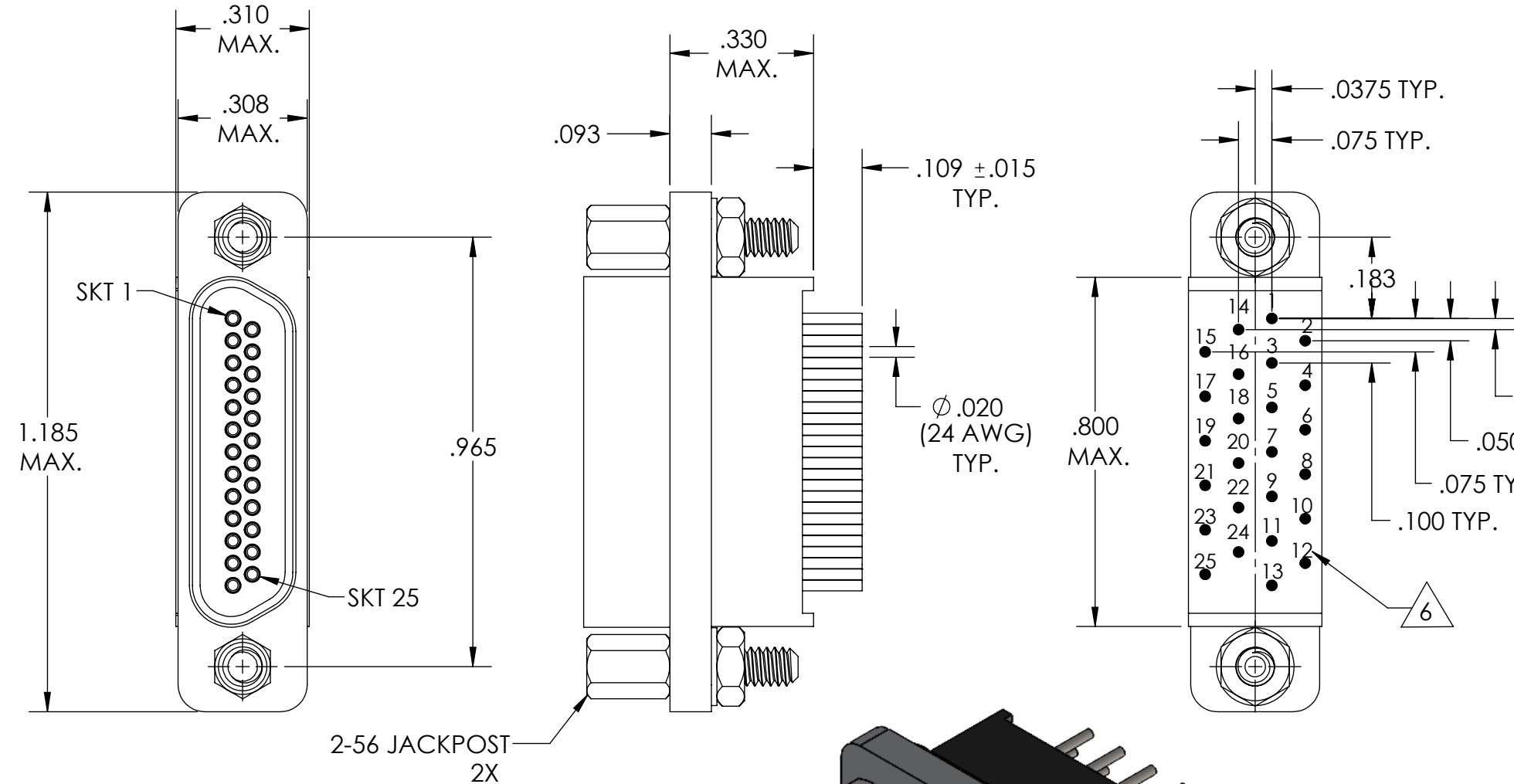

6 NUMBERS ARE REFERENCE ONLY AND DO NOT APPEAR ON ACTUAL ASSEMBLY.

5. CONTACT HEIGHTS ARE TO BE PER QA-STD-101.
4. PERFORMANCE SPECIFICATIONS:
 CURRENT RATING: 3 AMPS MAX.
 DWV: 600 VAC
 TEMPERATURE RATING: -55°C TO 125°C

3 MATERIALS:
 SHELL: 6061-T6 ALUMINUM PER AMS-QQ-A200/8, NICKEL PLATED PER AMS-2404
 INSULATOR/BACKSHELL: PPS PER MIL-M-24519 GST-40F, COLOR: BLACK
 SOCKET CONTACTS: C21000 COPPER ALLOY PER ASTM B36, GOLD PLATED PER ASTM B488
 24 AWG LEADS: TIN PLATED COPPER ALLOY PER A-A-59551, TYPE S
 HARDWARE: PASSIVATED STAINLESS STEEL IAW MIL-DTL-83513/5
 INTERFACIAL SEAL: FLUOROSILICONE PER MIL-R-25988

2. MARKING: "UMI", DATE CODE, UMI PART NUMBER, UMI WORK ORDER NUMBER
1. CONNECTOR ASSEMBLY IS IAW MIL-DTL-83513.

NOTES: UNLESS OTHERWISE SPECIFIED.

RECOMMENDED PCB LAYOUT

QUALITY SYMBOLS CRITICAL MAJOR NO SYMBOLS = MINOR DIMENSIONS	UNLESS OTHERWISE SPECIFIED: ALL DIMENSIONS ARE IN INCHES	SCALE 3:1	DWG SIZE B	THIRD ANGLE PROJECTION	REVISE ON CAD ONLY	
	GENERAL TOLERANCES: 3 PLACES ±.005 2 PLACES ±.01 ANGULAR ±2°	DRAWN BY & DATE DU 9/16/20		TITLE: MICRO-D CIRCUIT CONNECTOR, CM16R25S07-S01		
	ULTI-MATE CAGE CODE 58967	CHECKED BY & DATE DW 9/16/20		MATERIAL: 3	ENG PROJECT #: NONE	
		APPROVED BY & DATE DW 9/16/20		PART NO. 836241717	DRAWING NO. SD-836241717	
		CAD FILE NAME SD-836241717.sliddrw		THIS DRAWING CONTAINS INFORMATION THAT IS PROPRIETARY TO ULTI-MATE INCORPORATED AND SHOULD NOT BE USED WITHOUT WRITTEN PERMISSION.		