

PART REV	DWG ISSUE	DATE	ECN NO.	APPVD BY	REL BY
-	-	3-28-13	UMI 4923		

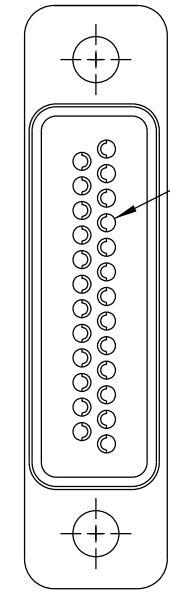
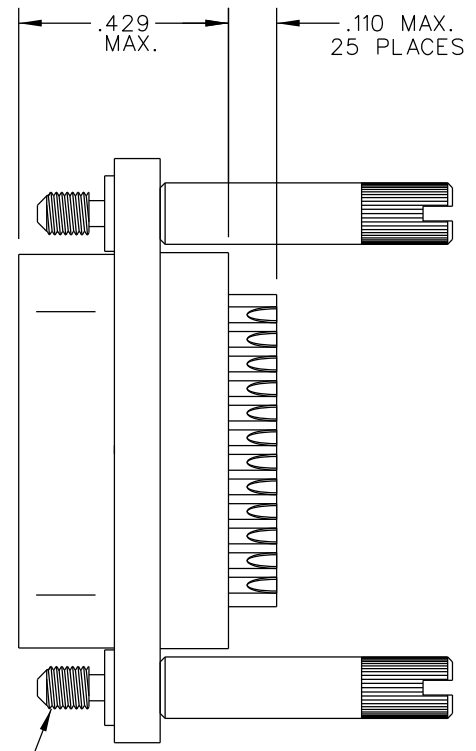
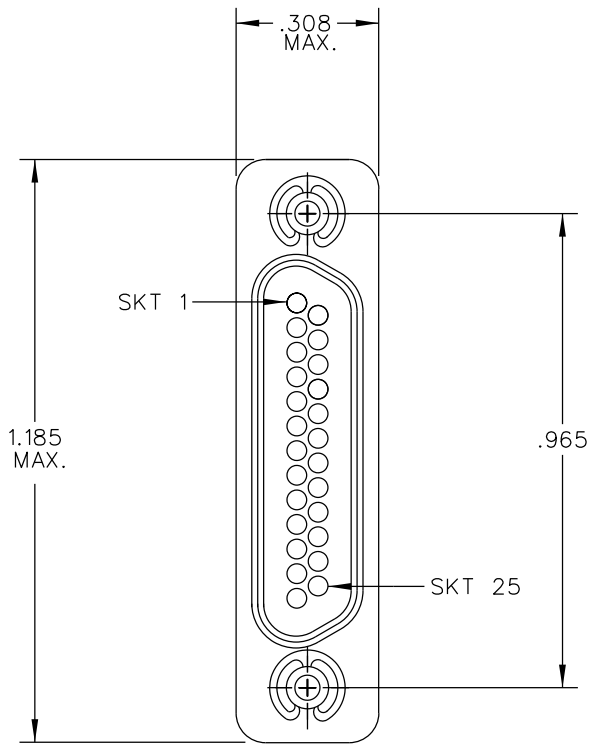

2-56 HIGH PROFILE  
SLOTTED HEAD JACKSCREW  
2 PLACES

2

**MATERIALS:**  
 SHELL: 6061-T6 ALUMINUM PER SAE-AMS-DD-A200/8,  
 NICKEL PLATED PER AMS 2404  
 INSULATOR: PPS PER MIL-M-24519 GST-40F, COLOR: BLACK  
 SOCKET CONTACT: C21000 COPPER ALLOY PER ASTM B36,  
 GOLD PLATED PER ASTM B488  
 INTERFACIAL SEAL: FLUOROSILICONE PER MIL-R-25988

1. MARKING: UMI, DATE CODE, UMI P/N.

NOTES: UNLESS OTHERWISE SPECIFIED.

QUALITY SYMBOLS MAJOR CRITICAL SPC	UNLESS SPECIFIED: ALL DIMENSIONS IN INCHES GENERAL TOLERANCES: 3 PLACE ±.005 2 PLACE ±.01 ANGULAR ±2°	SCALE 4 : 1 DWG SIZE B	THIRD ANGLE PROJECTION	REVISE ON CAD ONLY	
	Uti-Mate CAGE CODE <b>58967</b>	DRAWN BY & DATE DW 8-5-10 CHECKED BY & DATE SEE ECN APPROVED BY & DATE SEE ECN	TITLE: MICRO-D RECEPTACLE, SOLDER CUP SOCKET CONTACTS, MR25T06-S01		MATERIAL: 2
		CAD FILENAME SD-834241006.DGN	PART NO. 834241006	DRAWING NO. SD-834241006	SHEET NO. 1 OF 1
		THIS DRAWING CONTAINS INFORMATION THAT IS PROPRIETARY TO ULTI-MATE INCORPORATED AND SHOULD NOT BE USED WITHOUT WRITTEN PERMISSION.			

