

PART DWG REV ISSUE	DATE	ECN NO.	APP'D BY	REL BY
-	02/17/11	UM4304	T.POWERART	PER

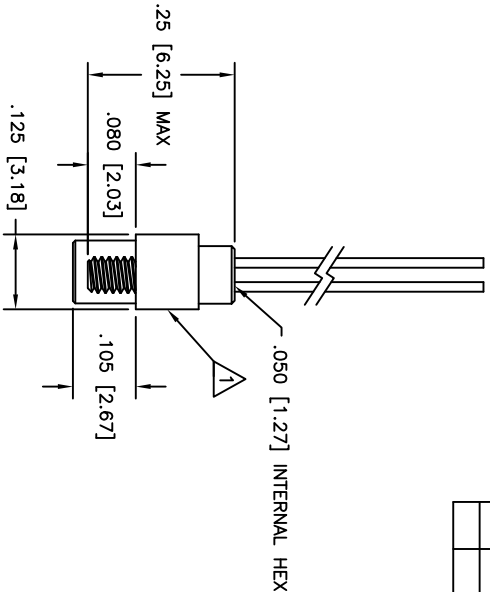

WIRING COLOR CODE

1, 11, 21, 31	BLACK
2, 12, 22, 32	BROWN
3, 13, 23, 33	RED
4, 14, 24, 34	ORANGE
5, 15, 25, 35	YELLOW
6, 16, 26, 36	GREEN
7, 17, 27, 37	BLUE
8, 18, 28	VIOLET
9, 19, 29	GRAY
10, 20, 30	WHITE

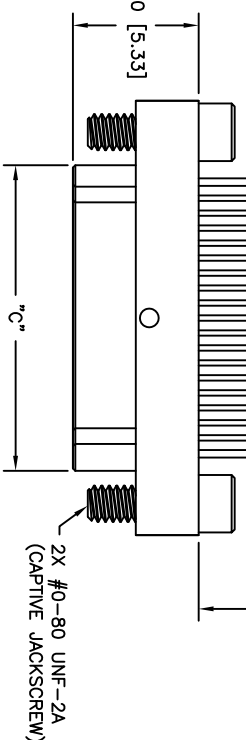
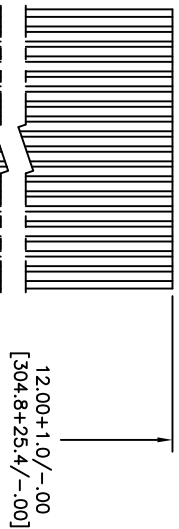
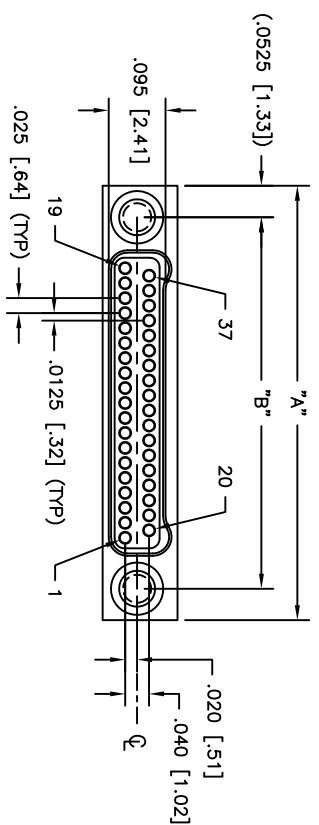

3. PERFORMANCE: MEETS OR EXCEEDS M32139 PERFORMANCE SPECIFICATIONS
 CONTACT RATING: 1 AMPERE MAXIMUM
 DMV: 250 VAC
 INSULATION RESISTANCE: 5000 MEGOHMS MINIMUM @ 100 VDC
 CONTACT RESISTANCE: 0.071 VOLT MAXIMUM DROP @ 1.0 AMPS (.071 OHMS)
 W/6.00" OF WIRE LISTED BELOW, PER MIL-DTL-32139

2. MATERIALS: SHELL: ALUMINUM 6061-T6, ELECTROLESS NICKEL PLATED PER AMS2404
 INSULATOR: LCP (LIQUID CRYSTAL POLYMER) GLCP-30F
 CONTACT: BERYLLIUM COPPER PER ASTM B194, GOLD PLATED PER ASTM B488
 LEADS: 30 AWG, NEMA HP3, TYPE ET, COLOR CODED PER MIL-DTL-681, SYSTEM 1,
 EXCEPT USING 10 SOLID REPEATING COLORS
 HARDWARE: 303 STAINLESS PER ASTM 582

1. MARKINGS: UMI, DATE CODE, UMI P/N AS SPACE PERMITS, OTHERWISE BAG OR TAG
 NOTES: UNLESS OTHERWISE SPECIFIED

PART NO.	SIZE	"A"	"B"	"C"
833311662	9	.375 [9.52]	.270 [6.86]	.160 [4.06]
833321662	15	.450 [11.43]	.345 [8.76]	.235 [5.97]
833331662	21	.525 [13.33]	.420 [10.67]	.310 [7.87]
833341662	25	.575 [14.60]	.470 [11.94]	.360 [9.14]
833351662	31	.650 [16.51]	.545 [13.84]	.435 [11.05]
833361662	37	.725 [18.41]	.620 [15.75]	.510 [12.95]
833371662	51	.900 [22.86]	.795 [20.19]	.685 [17.40]
833381662	65	1.075 [27.30]	.970 [24.64]	.860 [21.84]

QUALITY SYMBOLS	UNLESS SPECIFIED, ALL DIMENSIONS IN INCHES	SCALE	DWG SIZE	THIRD ANGLE PROJECTION	REVISE ON CAD ONLY
MAJOR =	GENERAL TOLERANCES:	5:1	B		
CRITICAL =	3 PLACE ±.005	DRAWN BY & DATE	09-28-15	TITLE	NANO-D DUAL ROW CONNECTOR
C =	2 PLACE ±.010	CHECKED BY & DATE		MATERIAL	MALE, SIZE XX, NMLXX-2P02-30F6-12.0 S01
S =	ANGULAR ±2°	APPROVED BY & DATE			
SPC SYMBOLS		SEE ECN			
		CAD FILENAME	SD-833361662.DWG	PART NO.	SD-833361662
		Uti+MATE CAGE CODE	58967	DRAWING NO.	SD-833361662
		THIS DRAWING CONTAINS INFORMATION THAT IS PROPRIETARY TO UTTI-MATE INCORPORATED AND SHOULD NOT BE USED WITHOUT WRITTEN PERMISSION.			
				SHEET NO.	1 OF 1
				REV	-