

3		2			
PART REV	DWG ISSUE	DATE	ECN NO.	APPVD BY	REL BY
-	-	02/17/11	UMI4304	T.POMBART	PER

WIRING COLOR CODE

1, 11, 21, 31, 41, 51, 61	— BLACK
2, 12, 22, 32, 42, 52, 62	— BROWN
3, 13, 23, 33, 43, 53, 63	— RED
4, 14, 24, 34, 44, 54, 64	— ORANGE
5, 15, 25, 35, 45, 55, 65	— YELLOW
6, 16, 26, 36, 46, 56	— GREEN
7, 17, 27, 37, 47, 57	— BLUE
8, 18, 28, 38, 48, 58	— VIOLET
9, 19, 29, 39, 49, 59	— GRAY
10, 20, 30, 40, 50, 60	— WHITE

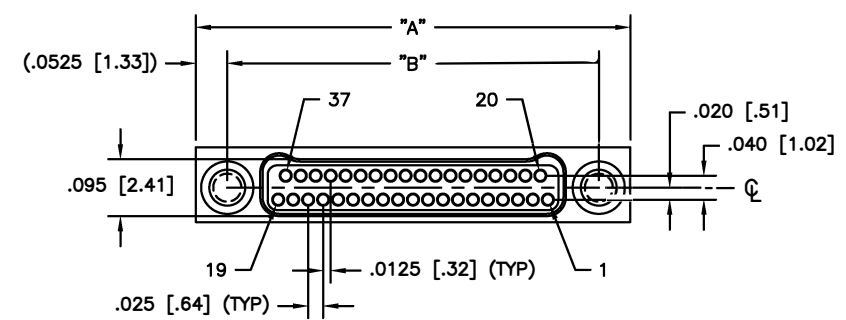
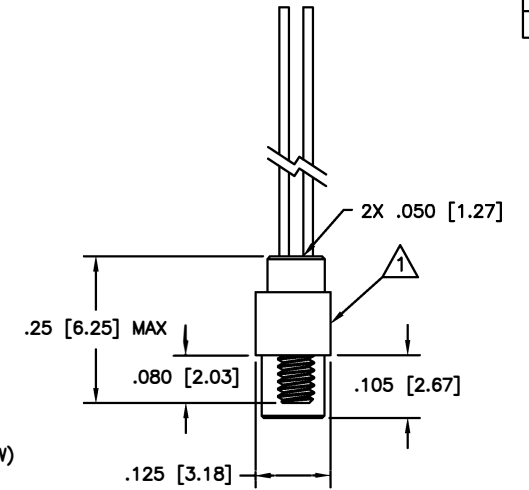
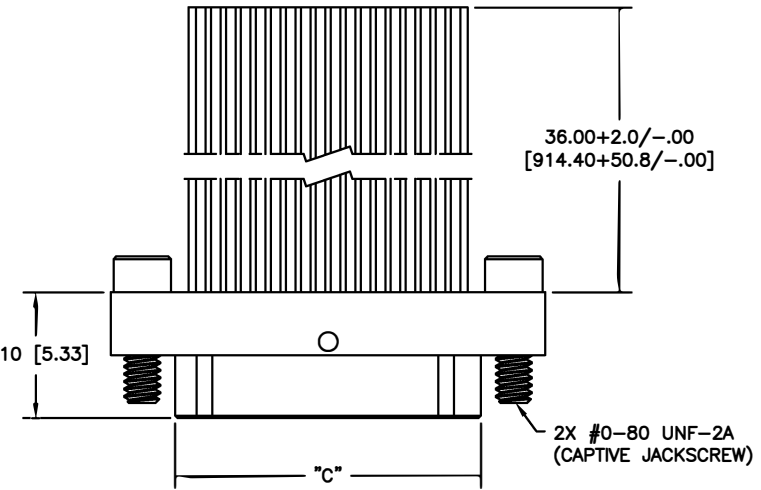

PART NO.	SIZE	"A"	"B"	"C"
833311632	9	.375 [9.52]	.270 [6.86]	.160 [4.06]
833321632	15	.450 [11.43]	.345 [8.76]	.235 [5.97]
833331632	21	.525 [13.33]	.420 [10.67]	.310 [7.87]
833341632	25	.575 [14.60]	.470 [11.94]	.360 [9.14]
833351632	31	.650 [16.51]	.545 [13.84]	.435 [11.05]
833361632	37	.725 [18.41]	.620 [15.75]	.510 [12.95]
833371632	51	.900 [22.86]	.795 [20.19]	.685 [17.40]
833381632	65	1.075 [27.30]	.970 [24.64]	.860 [21.84]

3. PERFORMANCE: MEETS OR EXCEEDS M32139 PERFORMANCE SPECIFICATIONS  
 CONTACT RATING: 1 AMPERE MAXIMUM  
 DWV: 250 VAC  
 INSULATION RESISTANCE: 5000 MEGOHMS MINIMUM @ 100 VDC  
 CONTACT RESISTANCE: 0.071 VOLT MAXIMUM DROP @ 1.0 AMPS (.071 OHMS)  
 W/6.00" OF WIRE LISTED BELOW, PER MIL-DTL-32139

2. MATERIALS: SHELL: ALUMINUM 6061-T6, ELECTROLESS NICKEL PLATED PER AMS2404  
 INSULATOR: LCP (LIQUID CRYSTAL POLYMER) GLCP-30F  
 CONTACT: BERYLLIUM COPPER PER ASTM B194, GOLD PLATED PER ASTM B488  
 LEADS: 30 AWG, NEMA HP3, TYPE ET, COLOR CODED PER MIL-DTL-681, SYSTEM 1,  
 EXCEPT USING 10 SOLID REPEATING COLORS  
 HARDWARE: 303 STAINLESS PER ASTM 582

1. MARKINGS: UMI, DATE CODE, UMI P/N AS SPACE PERMITS, OTHERWISE BAG OR TAG

NOTES: UNLESS OTHERWISE SPECIFIED

QUALITY SYMBOLS: MAJOR = CRITICAL = SPC =	UNLESS SPECIFIED: ALL DIMENSIONS IN INCHES	SCALE: 5:1	DWG SIZE: B	THIRD ANGLE PROJECTION	REVISE ON CAD ONLY
	GENERAL TOLERANCES: 3 PLACE ±.005 2 PLACE ±.010 ANGULAR ±2°	DRAWN BY & DATE: UMI 12-08-11	TITLE: NANO-D DUAL ROW CONNECTOR MALE, SIZE XX, NMLXX-2P02-30F6-36.0 S01		MATERIAL: Ulti-Mate Connector Inc.
		CHECKED BY & DATE: SEE ECN	PART NO. SD-833361632		
		APPROVED BY & DATE: SEE ECN	CAD FILENAME: SD-833361632.DWG	DRAWING NO. SD-833361632	SHEET NO. 1 OF 1

Ulti-Mate CAGE CODE 58967

THIS DRAWING CONTAINS INFORMATION THAT IS PROPRIETARY TO ULTI-MATE INCORPORATED AND SHOULD NOT BE USED WITHOUT WRITTEN PERMISSION.