

PART DWG REV ISSUE	DATE	ECN NO.	APPROV BY	REL BY
-	01/29/18	UM6532	T.POMBERT	PER

WIRING COLOR CODE

- 1, 11, 21, 31, 41, 51 — BLACK
- 2, 12, 22, 32, 42 — BROWN
- 3, 13, 23, 33, 43 — RED
- 4, 14, 24, 34, 44 — ORANGE
- 5, 15, 25, 35, 45 — YELLOW
- 6, 16, 26, 36, 46 — GREEN
- 7, 17, 27, 37, 47 — BLUE
- 8, 18, 28, 38, 48 — VIOLET
- 9, 19, 29, 39, 49 — GRAY
- 10, 20, 30, 40, 50 — WHITE

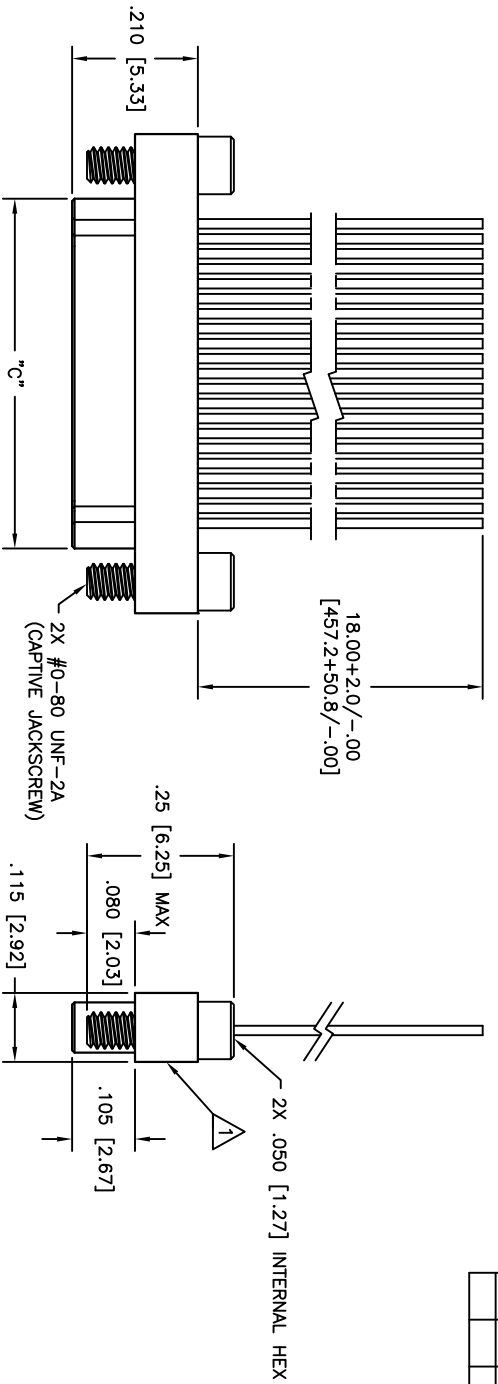

WIRE DIAGRAM REPRESENTS LARGEST SIZE IN PART NO. TABLE

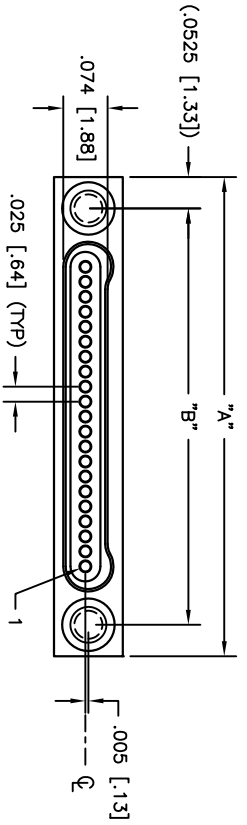

3. PERFORMANCE: MANUFACTURED TO MEET THE FOLLOWING M32139 PERFORMANCE SPECIFICATIONS
 CONTACT RATING: 1 AMPERE MAXIMUM
 DMV: 250 VAC
 INSULATION RESISTANCE: 5000 MEGOHMS MINIMUM @ 100 VDC
 CONTACT RESISTANCE: 0.071 VOLT MAXIMUM DROP @ 1.0 AMPS (.071 OHMS)
 W/6.00" OF WIRE LISTED BELOW, PER MIL-DTL-32139

2. MATERIALS: SHELL: ALUMINUM 6061-T6, ELECTROLESS NICKEL PLATED PER AMS2404
 INSULATOR: LCP (LIQUID CRYSTAL POLYMER) GLCP-30F
 CONTACT: BERYLLIUM COPPER PER ASTM B194, GOLD PLATED PER ASTM B488
 LEADS: 30 AWG, NEMA HP3, TYPE ET, COLOR CODED PER MIL-DTL-681, SYSTEM 1, EXCEPT USING 10 SOLID REPEATING COLORS
 HARDWARE: 303 STAINLESS PER ASTM 582

1. MARKINGS: UMI, UMI P/N, DATE CODE & W/O NO. AS SPACE PERMITS OTHERWISE ON BAG OR TAG
 NOTES: UNLESS OTHERWISE SPECIFIED

PART NO.	SIZE	"A"	"B"	"C"
833111622	9	.500 [12.70]	.395 [10.03]	.284 [7.21]
833121622	15	.650 [16.51]	.545 [13.84]	.434 [11.02]
833131622	21	.800 [20.32]	.695 [17.65]	.584 [14.83]
833141622	29	.900 [22.86]	.795 [20.19]	.684 [17.37]
833151622	31	1.050 [26.67]	.945 [24.00]	.834 [21.18]
833161622	37	1.200 [30.48]	1.095 [27.81]	.984 [24.99]
833171622	51	1.500 [39.37]	1.445 [36.70]	1.334 [33.86]

QUALITY SYMBOLS	UNLESS SPECIFIED, ALL DIMENSIONS IN INCHES	SCALE	DWG SIZE	THIRD ANGLE PROJECTION	REVISE ON CAD ONLY
MAJOR =	GENERAL TOLERANCES:	5:1	B		
CRITICAL =	3 PLACE ±.005	DRAWN BY & DATE			
C =	2 PLACE ±.010	UMI	03-09-10		
	ANGULAR ±2°	CHECKED BY & DATE			
		SEE ECN			
		APPROVED BY & DATE			
		SEE ECN			
SPC SYMBOLS		CAD FILENAME	PART NO.	DRAWING NO.	
S =		SD-833131622.DWG	SEE "TAB BLOCK"	SD-833131622	
		THIS DRAWING CONTAINS INFORMATION THAT IS PROPRIETARY TO ULTI-MATE			
		INCORPORATED AND SHOULD NOT BE USED WITHOUT WRITTEN PERMISSION			
		Uti-Mate	Connector Inc.	SHEET NO.	1 OF 1
		58967		PART REV	-