

PART DWG	DATE	ECN NO.	APP'D BY	REL BY
REV	ISSUE		T.POMBART	PER
A	08/07/15	UM65590		
A	11/13/16	UM6143	T.POMBART	PER

10 9 8 7 6 5 4 3 2

.010 [.25] X .005 [.13] (TYP)

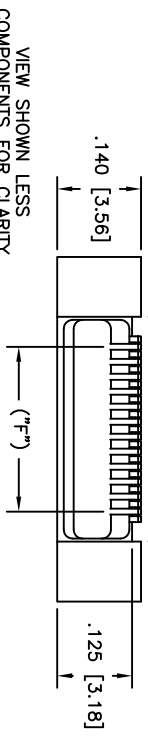

VIEW SHOWN LESS COMPONENTS FOR CLARITY

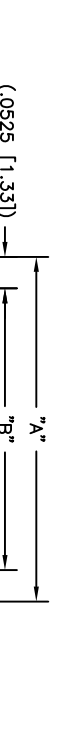
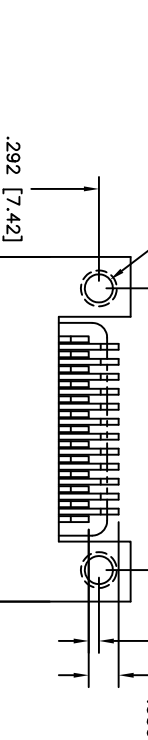

2X #0-80 UNF-2B

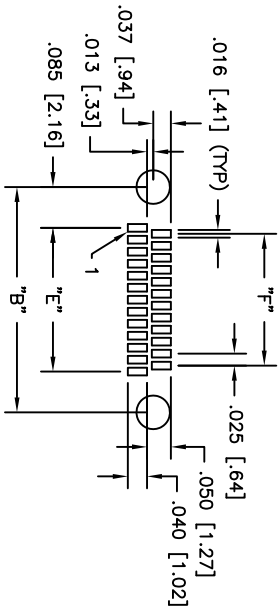
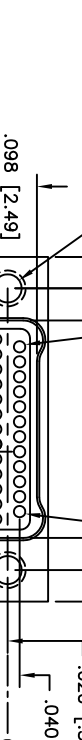

RECOMMENDED PC BOARD LAYOUT
(COMPONENT SIDE)
SCALE 4:1

PART NO.	SIZE	"A"	"B"	"C"	"D"	"E"	"F"
83241117	9	.375 [9.52]	.270 [6.86]	.163 [4.06]	.175 [4.44]	.100 [2.54]	.075 [1.90]
83242117	15	.450 [11.43]	.345 [8.76]	.238 [5.97]	.250 [6.35]	.175 [4.44]	.150 [3.81]
83243117	21	.525 [13.33]	.420 [10.67]	.313 [7.87]	.325 [8.25]	.250 [6.35]	.225 [5.71]
83244117	25	.575 [14.60]	.470 [11.94]	.363 [9.14]	.375 [9.52]	.300 [7.62]	.275 [6.98]
83245117	31	.650 [16.51]	.545 [13.84]	.438 [11.05]	.450 [11.43]	.375 [9.52]	.350 [8.89]
83246117	37	.725 [18.41]	.620 [15.75]	.513 [12.95]	.525 [13.33]	.450 [11.43]	.425 [10.79]
83247117	51	.900 [22.86]	.795 [20.19]	.688 [17.40]	.700 [17.78]	.625 [15.87]	.600 [15.24]
83248117	65	1.075 [27.30]	.970 [24.64]	.863 [21.84]	.875 [22.22]	.800 [20.32]	.775 [19.68]

- LEAD TOLERANCE: LOWEST LEAD TO BE CO-PLANAR WITHIN +.001/- .003 FROM SURFACE "X" THEN ALL LEADS TO BE WITHIN +.005 FROM LOWEST LEAD
- PERFORMANCE: MEETS OR EXCEEDS M32139 PERFORMANCE SPECIFICATIONS
CONTRACT RATING: 1 AMPERE MAXIMUM AT AMBIENT TEMPERATURE
DMV: 250 VAC
CONTACT RESISTANCE: 5000 MEGOHMS MINIMUM @ 100 VDC
INSULATION RESISTANCE: 0.021 VOLT MAXIMUM DROP @ 1.0 AMPS (.021 OHMS)
- MATERIALS: SHELL: ALUMINUM 6061-T6, ELECTROLESS NICKEL PLATED PER AMS2404
INSULATOR: LCP (LIQUID CRYSTAL POLYMER) GLCP-30F
CONTACT: BERYLLIUM COPPER PER ASTM B194, GOLD PLATED PER ASTM B488
LEADS: SN/PB PLATED
- MARKINGS: UMI, UMI P/N, DATE CODE & W/O NO. AS SPACE PERMITS OTHERWISE ON BAG OR TAG

UNLESS SPECIFIED, ALL DIMENSIONS IN INCHES

QUALITY SYMBOLS: \blacktriangle MAJOR, \triangle CRITICAL, ∇ SPC

GENERAL TOLERANCES:
3 PLACE \pm .005
2 PLACE \pm .010
ANGULAR \pm 2°

SCALE: 5:1
DRAWN BY & DATE: UMI 03-09-10
CHECKED BY & DATE:
APPROVED BY & DATE:

CAD FILENAME: SD-83244117.DWG
THIS DRAWING CONTAINS INFORMATION THAT IS PROPRIETARY TO ULTI-MATE INCORPORATED AND SHOULD NOT BE USED WITHOUT WRITTEN PERMISSION.

TITLE: NANO-D DUAL ROW CONNECTOR
FEMALE, SIZE XX, CNM38LXX-2S071-S01

MATERIAL: ∇

REVISION ON CAD ONLY

DRAWING NO.: SD-832441117
SHEET NO.: 1 OF 1
REV: A

Uti-Mate Connector Inc.

NOTES: UNLESS OTHERWISE SPECIFIED