

PART DWG	REV	DATE	ECN NO.	APPD BY	REL BY
A	A	04/27/15	UM5591	TPOWER	PER

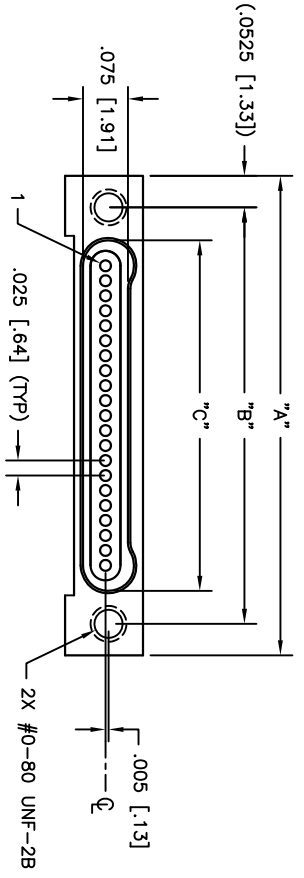
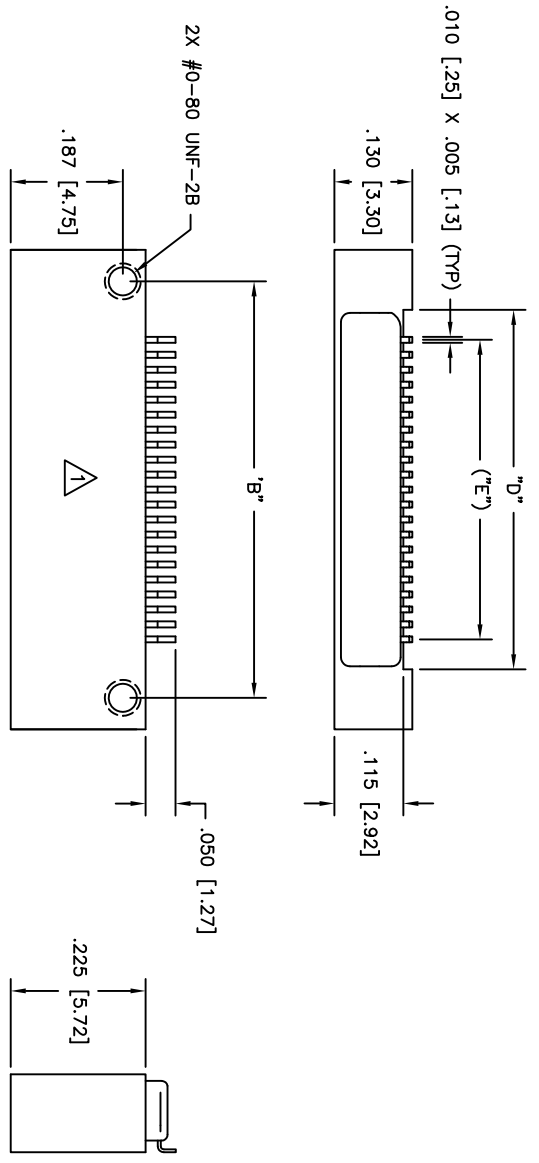
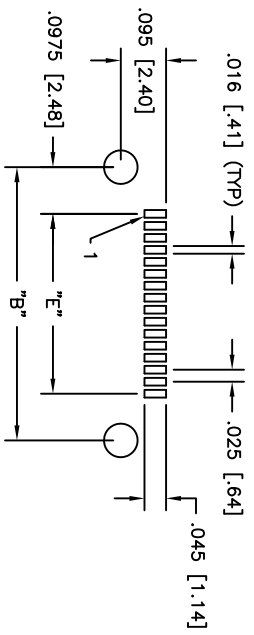

3. PERFORMANCE: MEETS OR EXCEEDS M32139 PERFORMANCE SPECIFICATIONS  
 CONTACT RATING: 1 AMPERE MAXIMUM  
 DMV: 250 VAC  
 INSULATION RESISTANCE: 5000 MEGOHMS MINIMUM @ 100 VDC  
 CONTACT RESISTANCE: 0.021 VOLT MAXIMUM DROP @ 1.0 AMPS (.021 OHMS)

△ MATERIALS: SHELL: ALUMINUM 6061-T6, ELECTROLESS NICKEL PLATED PER AMS 2404  
 INSULATOR: LCP (LIQUID CRYSTAL POLYMER) GLCP-30F  
 CONTACT: BERYLLIUM COPPER PER ASTM B194, GOLD PLATED PER ASTM B488  
 LEADS: Sn/Pb PLATED

△ MARKINGS: UMI, DATE CODE, UMI P/N AS SPACE PERMITS, OTHERWISE BAG OR TAG  
 NOTES: UNLESS OTHERWISE SPECIFIED

PART NO.	SIZE	"A"	"B"	"C"	"D"	"E"
832211217	9	.500 [12.70]	.395 [10.03]	.285 [7.24]	.300 [7.62]	.100 [2.54]
832221217	15	.650 [16.51]	.545 [13.84]	.435 [11.05]	.450 [11.43]	.175 [4.45]
832231217	21	.800 [20.32]	.695 [17.65]	.585 [14.86]	.600 [15.24]	.250 [6.35]
832241217	25	.900 [22.86]	.795 [20.19]	.685 [17.40]	.700 [17.78]	.300 [7.62]
832251217	31	1.050 [26.67]	.945 [24.00]	.835 [21.21]	.850 [21.59]	.375 [9.52]
832261217	37	1.200 [30.48]	1.095 [27.81]	.985 [25.02]	1.000 [25.40]	.450 [11.43]
832271217	51	1.500 [39.37]	1.445 [36.70]	1.335 [33.91]	1.350 [34.29]	.625 [15.88]

QUALITY SYMBOLS	UNLESS SPECIFIED, ALL DIMENSIONS IN INCHES	SCALE	DWG SIZE	THIRD ANGLE PROJECTION	REVISE ON CAD ONLY
MAJOR =	GENERAL TOLERANCES:	5:1	B		
CRITICAL =	3 PLACE ±.005	DRAWN BY & DATE	U		
C =	2 PLACE ±.010	CHECKED BY & DATE	U		
SPC =	ANGULAR ±2°	APPROVED BY & DATE	U		
		SEE ECN			
		CAD FILENAME	PART NO.	DRAWING NO.	
		Uti+Mate CAGE CODE	SD-832231217.DWG	SD-832231217	
		58967			
			THIS DRAWING CONTAINS INFORMATION THAT IS PROPRIETARY TO UTI+MATE INCORPORATED AND SHOULD NOT BE USED WITHOUT WRITTEN PERMISSION.		