

| REVISIONS | | | | | |
|-----------|------------|-----------|---------|-----------|---------|
| PART REV. | DWG. ISSUE | DATE | ECN NO. | APPVD. BY | REL. BY |
| - | - | 5/29/2020 | UMI7488 | JA | DW |

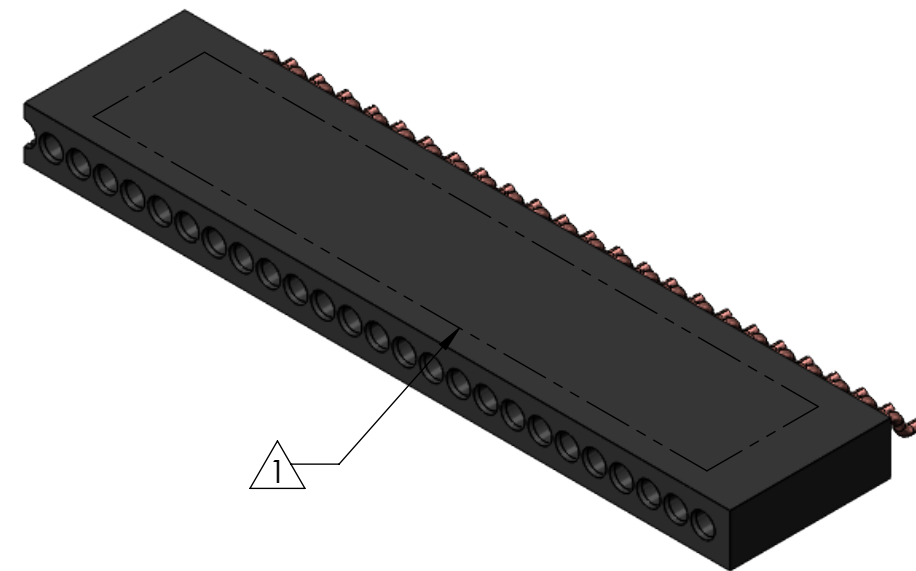
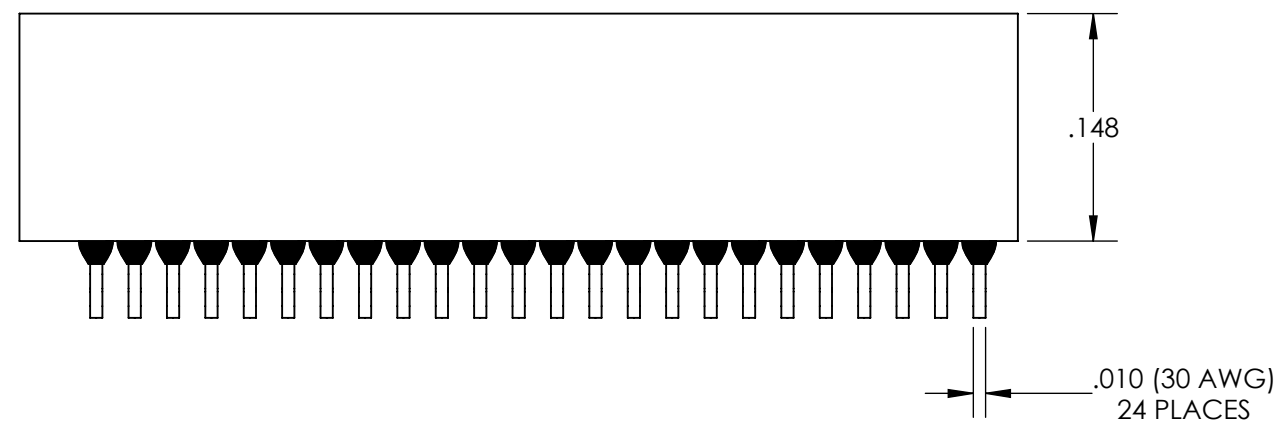
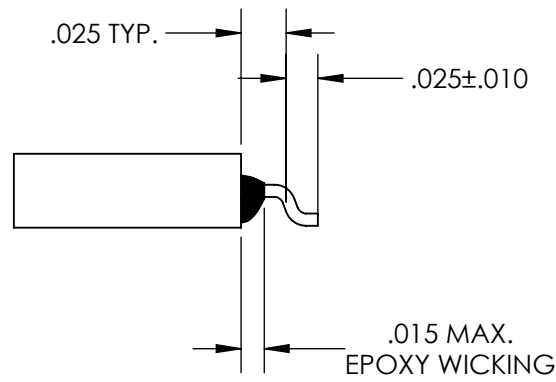
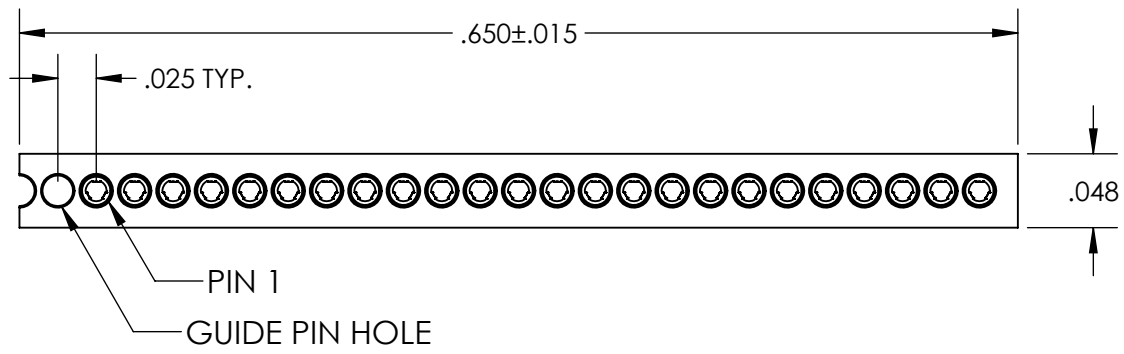

3. PERFORMANCE SPECIFICATIONS:
 CONTACT RATING: 1 AMP MAX.
 DWV: 250 VAC
 INSULATION RESISTANCE: 5000 MΩ MIN. @ 100 VDC
 TEMPERATURE RATING: 200°C

2 MATERIALS:
 INSULATOR: PPS (POLYPHENYLENE SULFIDE) PER MIL-M-24519 GST-40F
 CONTACTS: C17200 BERYLLIUM COPPER PER ASTM B194, GOLD PLATED PER ASTM B488
 LEADS: TIN PLATED COPPER ALLOY PER B49

1 MARKINGS: UMI, UMI PART NO., DATE CODE, AND WORK ORDER NO.

NOTES: UNLESS OTHERWISE SPECIFIED

| | | | | | | |
|---|---|--|---|------------------------|-----------------------------|----------------|
| QUALITY SYMBOLS CRITICAL SPL/MI NOR SPL/MAJOR KEY | UNLESS SPECIFIED: ALL DIMENSIONS IN INCHES GENERAL TOLERANCES: 3 PLACE ±.005 2 PLACE ±.010 ANGULAR ±2° | SCALE NONE | DWG SIZE B | THIRD ANGLE PROJECTION | REVISE ON CAD ONLY | |
| | ALL EXTERNAL SPECIFICATIONS REFERENCED ON THIS DRAWING SHALL BE THE LATEST REVISION IN EFFECT UMI-Mate CAGE CODE 58967 | DRAWN BY & DATE JA 5/29/2020 | TITLE NANO STRIP CONNECTOR, PLUG, NSR24P1-L05 | | MATERIAL 2 | |
| | | CHECKED BY & DATE SEE ECN | ENG PROJECT # UMI-Mate Connector Inc. | | DRAWING NO. SD-437245021 | |
| | | APPROVED BY & DATE SEE ECN | CAD FILENAME SD-437245021.slddrw | PART NO. 437245021 | SHEET NO. 1 OF 1 | PART REV. - |
| | | THIS DRAWING CONTAINS INFORMATION THAT IS PROPRIETARY TO ULTI-MATE INCORPORATED AND SHOULD NOT BE USED WITHOUT WRITTEN PERMISSION. | | | | |