

PART REV	DWG ISSUE	DATE	ECN NO.	APPVD BY	REL BY
-	-	11/19/15	UMI5808	DW	DW

F
E
D
C
B
A

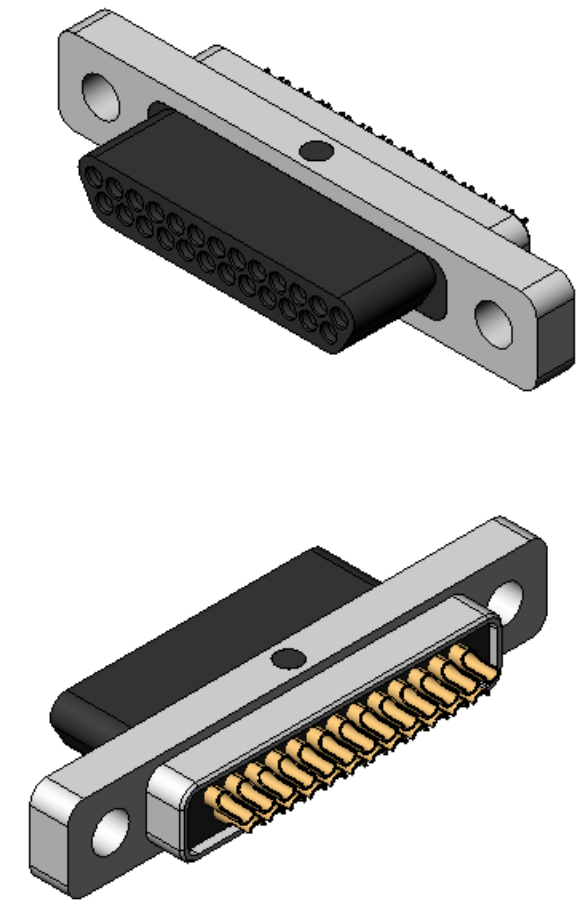
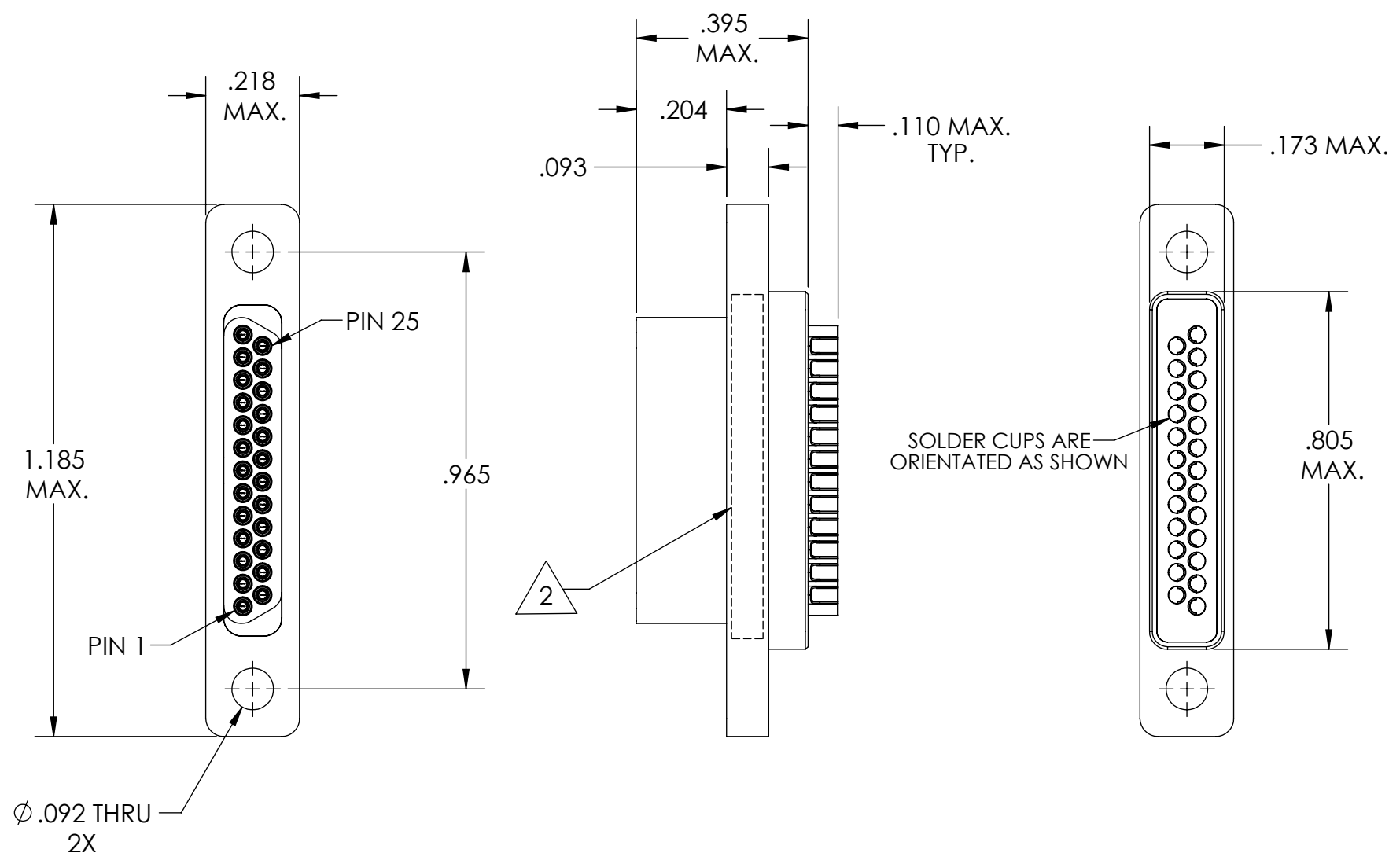

SOLDER CUPS ARE ORIENTATED AS SHOWN

4. PERFORMANCE SPECIFICATIONS (AT AMBIENT TEMPERATURE):
 CURRENT RATING: 3 AMPS MAX.
 INSULATION RESISTANCE: 5000 MEGOHMS MIN.
 DWV: 600 VAC
 TEMPERATURE RATING: 200° C

3 MATERIALS:
 SHELL: 6061-T6 ALUMINUM PER AMS-QQ-A200/8, NICKEL PLATED PER AMS-2404
 INSULATOR: PPS PER MIL-M-24519 GST-40F, COLOR: BLACK
 PIN SOLDER CUP CONTACTS: C17200 BERYLLIUM COPPER PER ASTM B194, GOLD PLATED PER ASTM B488

2 MARKING: "UMI", DATE CODE, UMI PART NUMBER

1. CONNECTOR ASSEMBLY IS IAW MIL-DTL-83513 UNLESS OTHERWISE SPECIFIED.

NOTES: UNLESS OTHERWISE SPECIFIED.

QUALITY SYMBOLS CRITICAL MAJOR NO SYMBOLS = MINOR DIMENSIONS	UNLESS OTHERWISE SPECIFIED: ALL DIMENSIONS ARE IN INCHES	SCALE 3:1	DWG SIZE B	THIRD ANGLE PROJECTION	REVISE ON CAD ONLY		
	GENERAL TOLERANCES: 3 PLACES ±.005 2 PLACES ±.01 ANGULAR ±2°	DRAWN BY & DATE DU 11/19/15	TITLE: LOW-PROFILE MICRO-D CONNECTOR, APR25N0-S01-HT, HIGH-TEMP			MATERIAL: 3	ENG PROJECT #: NONE
	ULTI-MATE CAGE CODE 58967	CHECKED BY & DATE DW 11/19/15	APPROVED BY & DATE DW 11/19/15	CAD FILE NAME SD-434341000.SLDDRW	PART NO. 434341000	DRAWING NO. SD-434341000	SHEET NO. 1 of 1
	THIS DRAWING CONTAINS INFORMATION THAT IS PROPRIETARY TO ULTI-MATE INCORPORATED AND SHOULD NOT BE USED WITHOUT WRITTEN PERMISSION.						PART REV. -

