

PART/DWG REV ISSUE	DATE	ECN NO.	APP'D BY	REL BY
A B	11/13/16	UMI6143	T.POMBART	PER
A C	03/13/17	UMI6267	T.POMBART	PER

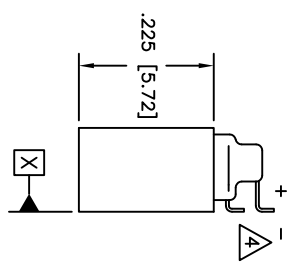
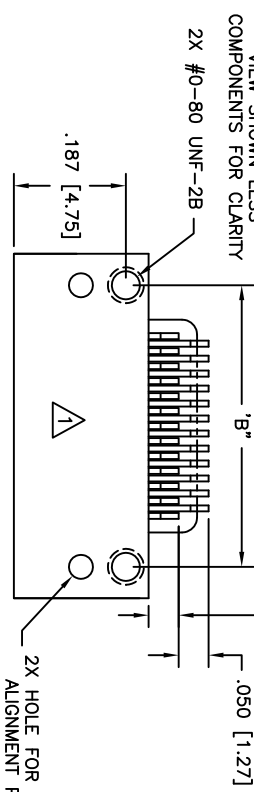
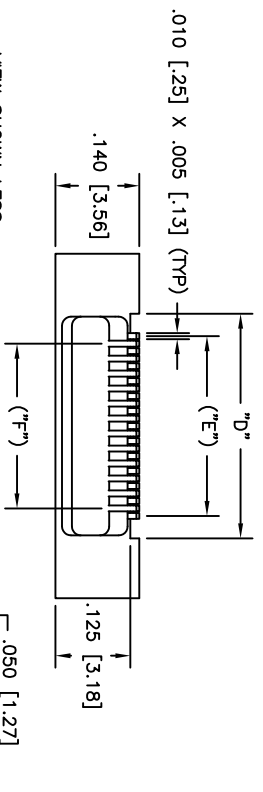

PART NO.	SIZE	"A"	"B"	"C"	"D"	"E"	"F"
432411227	9	.375 [9.52]	.270 [6.86]	.163 [4.06]	.175 [4.44]	.100 [2.54]	.075 [1.90]
432421227	15	.450 [11.43]	.345 [8.76]	.238 [5.97]	.250 [6.35]	.175 [4.44]	.150 [3.81]
432431227	21	.525 [13.33]	.420 [10.67]	.313 [7.87]	.325 [8.25]	.250 [6.35]	.225 [5.71]
432441227	25	.575 [14.60]	.470 [11.94]	.363 [9.14]	.375 [9.52]	.300 [7.62]	.275 [6.98]
432451227	31	.650 [16.51]	.545 [13.84]	.438 [11.05]	.450 [11.43]	.375 [9.52]	.350 [8.89]
432461227	37	.725 [18.41]	.620 [15.75]	.513 [12.95]	.525 [13.33]	.450 [11.43]	.425 [10.79]
432471227	51	.900 [22.86]	.795 [20.19]	.688 [17.40]	.700 [17.78]	.625 [15.87]	.600 [15.24]
432481227	65	1.075 [27.30]	.970 [24.64]	.863 [21.84]	.875 [22.22]	.800 [20.32]	.775 [19.68]

- 1. MARKINGS: UMI, UMI P/N, DATE CODE & W/O NO. AS SPACE PERMITS OTHERWISE ON BAG OR TAG
- 2. MATERIALS: SHELL: ALUMINUM 6061-T6, ELECTROLESS NICKEL PLATED PER AMS2404
INSULATOR: LCP (LIQUID CRYSTAL POLYMER) GLCP-30F
CONTACT: BERYLLIUM COPPER PER ASTM B194, GOLD PLATED PER ASTM B488
LEADS: GOLD LEADS (RoHS COMPLIANT)
EPOXY: 200° CELSIUS
- 3. PERFORMANCE: MEETS OR EXCEEDS M32139 PERFORMANCE SPECIFICATIONS
CONTACT RATING: 1 AMPERE MAXIMUM AT AMBIENT TEMPERATURE
DWV: 250 VAC
INSULATION RESISTANCE: 5000 MEGOHMS MINIMUM @ 100 VDC
CONTACT RESISTANCE: 0.021 VOLT MAXIMUM DROP @ 1.0 AMPS (.021 OHMS)
- 4. LEAD TOLERANCE: LOWEST LEAD TO BE CO-PLANAR WITHIN +.001/- .003 FROM SURFACE
"X" THEN ALL LEADS TO BE WITHIN +.005 FROM LOWEST LEAD

QUALITY UNLESS SPECIFIED:
MAJOR ALL DIMENSIONS IN INCHES
CRITICAL GENERAL TOLERANCES:
3 PLACE ±.005
2 PLACE ±.010
ANGULAR ±2°

SCALE: 5:1
DRAWN BY & DATE: PER 07-15-14
CHECKED BY & DATE: SEE ECN
APPROVED BY & DATE: SEE ECN

CAD FILENAME: SD-432441227.DWG
THIS DRAWING CONTAINS INFORMATION THAT IS PROPRIETARY TO ULTI-MATE
INCORPORATED AND SHOULD NOT BE USED WITHOUT WRITTEN PERMISSION.

TITLE: NANO-D DUAL ROW CONNECTOR
FEMALE, SIZE XX, CNM28LXX-25072-S01 HT

MATERIAL:

DRAWING NO. SD-432441227
CONNECTOR INC.

Uti-M Connector Inc.

SHEET NO. 1 OF 1
REV A

NOTES: UNLESS OTHERWISE SPECIFIED